

KINWAT PARISAR FARMERS PRODUCER CO. LTD.
GAT NO 173/1, MANDAWA, TAL-KINWAT, DIST- NANDED.

152

RECAPULATION SHEET
FINAL

NAME OF WORK :- PROPOSED CONSTRUCTION OF 1020 MT CAP.WH BLDG WITH ANCILLARY WORKS AT GUT NO 173/1 ,MANDAWA
KINWAT, DIST- NANDED.

Based on E SSR -2021-22

PARTICULARS	Cap.		Unit	AMOUNT	1020	
					Cost per	MT
Sub Work :-I Const. of 1020 MT WH Bldg.	1020	MT	Rs	8546895	8379	Cost per MT
Sub Work II :- Electrification		2.5%	Rs	213672		
Sub Work III :- Royalty Charges			Rs	128295		
Sub work IV:- Material Lab Testing charges			Rs	41740		
	TOTAL COST			8930602	8755	Cost per MT
Add GST	18%		Rs	1607508		
Add L.I.	0.5%		Rs	44653		
	Grand Total			Rs <u>10582764</u>	10375	Cost per MT
	Say			<u>10582771</u>		

Vijay G. Nageshwar
Reg.No. TP/STATE/R/2022/APL/S-I.....
Regd. Architect DIM & Consulting Engineer
Venkatesh Nagar, NANDED.
Call: 9830144232, 9637881309

KINWAT PARISAR FARMERS PRODUCER CO. LTD.
GAT NO 173/1, MANDAWA, TAL-KINWAT, DIST- NANDED.

Sub Work :-I Const. of 1020 MT WH Bldg.

LN.	DESCRIPTION OF ITEM	QTY.	UNIT	LN./ P.N	BASIC RATE	LEAD CHARGES SAND HM	METAL Bricks	TS & R.A	TOTAL	Add 10 % Tribal Area Charges 0.100	TOTAL OF RATES 6 TO 11	ADD FOR CHARGES 9.0000	%	TOTAL OF RATES 6 TO 14	AMOUNT
1	Excavation for foundation in earth, soil of all types, sand, gravel and soft murum, including removing the excavated material up to a distance of 50 m. beyond the building area and stacking and spreading as directed, dewatering, preparing the bed for the foundation and necessary back filling, ramming, watering including shoring and strutting etc. complete. (Lift upto 1.5 m.) By Mechanical Means	123.00	Cum	21.02/115	193.00				193.00	19.30	212.30	0.00		212.30	26113
2	Excavation for foundation in earth, soils of all types, sand, gravel and soft murum, including removing the excavated material upto a distance of 50 metres beyond the building area and stacking and spreading as directed, dewatering, preparing the bed for the foundation and necessary back filling, ramming, watering including shoring and strutting etc. complete. (Lift from 1.5m to 3.0m) By Mechanical Means	0.50	Cum	21.04/115	241.00				241.00	24.10	265.10	0.00		265.10	133
3	Excavation for foundation in hard murum including removing the excavated material upto distance of 50 metres beyond the building area and stacking and spreading as directed, dewatering, preparing the bed for the foundation and necessary back filling, ramming, watering including shoring and strutting etc. complete. (Lift upto 1.50 m) By Mechanical Means	46.00	Cum	21.06/148	212.00				212.00	21.20	233.20	0.00		233.20	10728
4	Excavation for foundation in Hard murum including removing the excavated material upto a distance of 50 metres beyond the building area and stacking and spreading as directed, dewatering, preparing the bed for the foundation and necessary back filling, ramming, watering including shoring and strutting etc. complete. (Lift upto 1.5m to 3.0m) By Mechanical Means	0.50	Cum	21.08/115	265.00				265.00	26.50	291.50	0.00		291.50	146
5	Excavation for foundation in hard murum and boulders including removing the excavated material up to a distance 50 metres, beyond the building area and stacking and spreading as directed, dewatering, preparing the bed for the foundation and necessary back filling, ramming, watering including shoring and strutting etc. complete. (Lift upto 1.5m.) By Mechanical Mean	16.00	Cum	21.10/115	235.00				235.00	23.50	258.50	0.00		258.50	4136
6	Excavation for foundation in Hard murum and boulders including removing the excavated material upto a distance of 50 metres, beyond the building area and stacking and spreading as directed, dewatering, preparing the bed for the foundation and necessary back filling, ramming, watering including shoring and strutting etc. complete. (Lift from 1.5 m to 3.0 m.) By Mechanical Means	1.00	Cum	21.12/115	291.00				291.00	29.10	320.10	0.00		320.10	321

7	Excavation for roadway in earth, soil of all sorts, sand, gravel or soft murum including dressing section to the required grade, camber and side slopes and conveying the excavated materials with all lifts upto a lead of 50m. and spreading for embankment or stacking as directed.	55.00	Cum	2.11/23	104.00					104.00	10.40	114.40	0.00	114.40	6292
8	Excavation for roadway in hard murum and boulder including dressing section to the required grade, camber and side slopes and conveying the excavated materials with all lifts upto a lead of 50m and spreading for embankment or stacking as directed.	1.00	Cum	2.13/23	121.00					121.00	12.10	133.10	0.00	133.10	134
9	Providing and laying Cast in situ/Ready Mix cement concrete in M-10 of trap/ granite/ quartzite/ gneiss metal for foundation and bedding including bailing out water, Steel centering, formwork, laying/pumping, compacting, roughening them if special finish is to be provided, finishing if required and curing complete, with fully automatic micro processor based PLC with SCADA enabled reversible Drum Type mixer/concrete Batch mix	65.00	Cum	24.01/129	5538	595.57	-120.00			6013.57	601.36	6614.93	0.00	6614.93	429971
10	Providing uncoursed rubble masonry of trap / granite / quartzite / gneiss stones in cement mortar 1:6 in foundation and plinth of inner walls / in plinth of external walls including bailing out water manually , striking joints on an exposed faces and watering etc.complete	1.00	cu m	28.01/146	4757					4757.00	475.70	5232.70	0.00	5232.70	5233
11	Providing second class Burnt Brick masonry with conventional/ I.S. type bricks in cement mortar 1:6 in foundations and plinth of inner walls/ in plinth external walls including bailing out water manually , striking joints	30.45	Cum	27.01/144	7343	318.60				7661.60	766.16	8427.76	0.00	8427.76	256608
12	Providing & laying 35 cms wide single layer tarfelt by applying initial coat of shallbond @ 1kg/sqm fixing in place by wire nails for D.P.C. at plinth as directed by	34.00	Sqm	R.A.	349.25					349.25		349.25	0.00	349.25	11875
13	Providing and fixing in position TMT - FE - 500 bar reinforcement of various diameters for R.C.C. pile caps, footings, foundations, slabs, beams columns, canopies, staircase, newels, chajjas, lintels pardis, copings, fins, arches etc. as per detailed designs, drawings and schedules including cutting, bending, hooking the bars, binding with wires or tack welding and supporting as required complete.	10.00	MT	26.33/139	71778.00					71778.00	7177.80	78955.80	0.00	78955.80	789558
14	Providing and laying in situ /Ready Mix cement concrete M-20 of trap / granite /quartzite/ gneiss metal for R.C.C. work in foundations like raft, strip foundations, grillage and footings of R.C.C. columns and steel stanchions etc. including bailing out water. Steel centering formwork, laying/pumping cover blocks, compaction and curing roughening the surface if special finish is to be provided (Excluding reinforcement and structural steel) etc.	25.09	Cum	25.11/133	6666.00	538.55	-120.00			7084.55	708.45	7793.00	0.00	7793.00	195542

15	Providing and laying Cast in situ/Ready Mix cement concrete M-20 of trap / granite / quartzite / gneiss metal for R.C.C. columns as per detailed designs and drawing or as directed including steel centering, formwork, cover blocks, laying/pumping, compaction finishing the formed surfaces with cement mortar 1:3 of sufficient minimum thickness to give a smooth and even surface or roughening if special finish is to be provided and curing	29.58	Cum	25.31/134	12987.00	538.55	-120.00	13405.55	1340.55	14746.10	0.00	14746.10	436190
16	Providing and laying Cast in situ/Ready Mix cement concrete M-20 of trap / granite / quartzite / gneiss metal for R.C.C. beams and lintels as per detailed designs and drawings or as directed including steel centering, formwork, cover blocks, laying/pumping, compaction and roughening the surface if special finish is to be provided and curing etc. complete. (Excluding reinforcement and structural steel), with fully automatic micro processor	43.00	Cum	25.50/135	11483.00	538.55	-120.00	11901.55	1190.15	13091.70	0.00	13091.70	562944
17	Providing and laying Cast in situ/Ready Mix cement concrete M-20 of trap / granite / quartzite / gneiss metal for R.C.C. chajja as per detailed design and drawings including steel centering, formwork, cover blocks, laying/pumping, compacting and roughening the surface if special finish is to be provided and curing complete. (Excluding reinforcement and structural steel), with fully automatic micro processor based PLC with SCADA	2.19	Cum	26.05/137	13111.00	538.55	-120.00	13529.55	1352.95	14882.50	0.00	14882.50	32593
18	Providing and laying Cast in situ/Ready Mix cement concrete M-20 of trap / granite / quartzite / gneiss metal for R.C.C. slabs and landings as per detailed designs and drawings including steel centering, formwork, cover blocks, laying/pumping, compaction finishing the formed surfaces with cement mortar 1:3 of sufficient minimum thickness to give a smooth and even surface or roughening if special finish is to be provided and curing etc. complete. With fine aggregate (Crushed sand VSI)	2.28	Cum	25.70/135	13943.00	538.55	-120.00	14361.55	1436.15	15797.70	0.00	15797.70	36000
19	Providing second class Burnt Brick masonry with conventional/I.S. type brick since mentmortar 1:6 in superstructure including striking joints, raking out joints, watering and scaffolding etc. Complete	90.76	Cum	27.05/144	7570.00	318.60		7888.60	788.86	8677.46	0.00	8677.46	787566
20	Providing and laying Cast in situ/Ready Mix cement concrete M-15 of trap / granite / quartzite / gneiss metal for coping to plinth or parapet, moulded or chamfered as per drawing or as directed including steel centering, plywood/ steel formwork compacting, roughening them if special finish is to be provided, finishing uneven and honeycombed surface and curing etc. complete. The Cement Mortar 1:3 plaster is considered for rendering	1.00	Cum	24.16/132	6030.00	557.55	-120.00	6467.55	646.76	7114.31	0.00	7114.31	7115
21	Providing sand faced plaster externally in cement mortar using approved screened sand, in all positions including base coat of 15 mm thick in cement mortar 1:4 using waterproofing compound at 1 Kilogramper cement bag curing the same for not less than 2 days and keeping the surface of the base coat rough to receive the sand faced treatment 6 to 8 mm thick in cement mortar 1:4 finishing the surface by taking out grains and curing for fourteen days scaffolding etc. complete.	751.00	Sqm	32.11/153	599.00	15.84		614.84	61.48	676.33	0.00	676.33	507924

22	Providing internal cement plaster 12 mm thick in Single coats in cement mortar 1:4 without neeru finish, to concrete, brick surface, in all positions including scaffolding and curing etc.complete.	584.00	Sqm	32.04/153	264.00	15.84				279.84	27.98	307.83	0.00	307.83	179773
23	Providing internal cement plaster 20mm thick in Single coats in cement mortar 1:4 with neeru finish, to concrete, brick surface, in all positions including scaffolding and curing etc complete.	108.00	Sqm	32.04/153 /32.21/154	332.00	15.84				347.84	34.78	382.63	0.00	382.63	41325
24	Providing and applying three coats of water proof cement paint of approved manufacture and of approved colour to new plastered surfaces including scaffolding if necessary, cleaning and preparing the surface, watering for two days etc. complete.	554.00	Sqm	35.15/165	97.00					97.00	9.70	106.70	0.00	106.70	59112
25	Providing and applying two coats of exterior acrylic emulsion paint confirming to corresponding I.S. of approved manufacture and of approved colour to the plastered surfaces including cleaning, preparing the plaster surface, applying primer coat, scaffolding if necessary, cleaning and preparing the surface for two days etc.	602.00	Sqm	35.25/165	240.00					240.00	24.00	264.00	0.00	264.00	158928
26	Providing and applying two coats (exterior quality) of flat oil paint of approved colour and shade to the plastered surface in buildings and workshops including scaffolding if necessary, cleaning the surface and preparing surface etc. complete. (excluding primer coat)	106.00	Sqm	35.11/164	83.00					83.00	8.30	91.30	0.00	91.30	9678
27	Providing and fixing rolling shutter fabricated from steel laths of minimum thickness 0.9 mm with lock plate of 3.15 mm thickness reinforced with 35 x 35 x 5 mm angle section fitted with sliding bolts and handles for both sides, deep M.S. channel section of depth and thickness not less than 65 mm and 3.15 mm respectively with hold fast arrangements, M.S. Bracket plate 300 x 300 x 3.15 mm minimum size and shape with square bar, suspension shaft of minimum 32 mm diameter, hood cover of M.S.	22.00	Sqm	39.24/181	4310.00					4310.00	431.00	4741.00	0.00	4741.00	104302
28	Providing and fixing mildsteel grill work for windows, ventilator etc. 20Kilogram/Square Metre as per drawing including fixtures, necessary welding and painting with one coat of anticorrosive paint and two coats of oil	17.00	Sqm	40.01/192	1845.00					1845.00	184.50	2029.50	0.00	2029.50	34502
29	Providing structural steel work in trusses, other similar trussed purlins and members with all bracing, gusset plates etc. as per detailed designs and drawings or as directed including cutting, fabricating, hoisting, erecting, fixing in position. Making riveted/ bolted/ welded connection and one coat of anticorrosive paint and over it 2 coats of oil painting approved quality and shade etc. complete.	14.28	M T	23.04/129	105909.00					105909.00	10590.90	116499.90	0.00	116499.90	1663977
30	Providing and fixing colour coated Zinalume (R) AZ150 (min 150 gms/sq.mt. total on each side) profiled sheets for roofing. The feed material is manufactured out of nominal 0.45 mm Base Metal Thickness (BMT) (0.5 mm TCT), Hi-strength steel with min 550 MPa yield strength, metallic hot dip coated with Aluminium-Zinc alloy (55%	655.00	Sqm	38.34/173	1095.00					1095.00	109.50	1204.50	0.00	1204.50	788948

31	Providing and fixing of colour Zincalume (R) AZ150 (Min 150gms/Sq mt. total on each sides) profiled sheets for Ridges. The feed material is manufactured out of nominal 0.45mm Base Metal Thickness (BMT) (0.5mm TCT). Hi-strength steel with min 550 MP a yield strength, metallic hot dip coated with Aluminium-Zinc alloy (55% aluminium 43.4 % zinc 1.6 % silicon) with COLORBOND (R) steel quality super durable polyester	36.90	Rum	38.35/174	702.00			702.00	70.20	772.20	0.00	772.20	28495
32	Providing and fixing wind appareted tarbo S. S. ventiletar system (24 inch dia.) over exsiting roof including cutting of sheet .propar fixing in position to true line & level with all fixtures & fastning, providing 0.8mm thick FRP sheet for covering area between roof and fan so as to provide waterproof joints with approved water proffing compound making good the roof surface including cleaning etc. complete (General application for all types of roofs for	16.00	Nos	42/374	8680.00			8680.00	868.00	9548.00	0.00	9548.00	152768
33	Providing & constructing parapet coping of size 35 x 35 cms in cement mortar 1:4 with conical top and side drops and round finish at A.C. sheet joints including finishing the whole with 20 mm thick cement plaster 1:4 with cement finish. 1.	34.20	RMT	R A	1179.00			1179.00		1179.00	0.00	1179.00	40322
34	Filling in plinth with approved excavated stuff obtained from departmental land including watering, compacting etc. complete as directed. (Bd. A.10/262)	109.00	Cum	21.36/117	113.00			113.00	11.30	124.30	0.00	124.30	13549
35	Providing Hard Murum cohesive non-swelling materials in plinth in layers of 20 cms etc. complete as directed. [Only compacted thickness is payable [Rd.23/202 & Rd.28/205].	103.00	Cum	RA	628.69			628.69		628.69	0.00	628.69	64756
36	Compacting the Hard Murum, cohesive non swelling materials in plinth upto 200 mm loose with power roller 8 to 10 tonne capacity including artificial watering etc. complete as directed. [Rd.38/210]	1021.00	Sqm	2.31/24	19.00			19.00	1.90	20.90	0.00	20.90	21339
37	Providing & laying stone metal layer of 20 cm thickness with 60 mm over size metal 65% and 40 mm size metal 35% with sand or stone chips spreading & leveling handpacking complete. [Rd.22/201, Rd.20/200 & Rd.20/205.]	274.00	Cum	RA	1357.50			1357.50		1357.50	0.00	1357.50	371955
38	Compacting oversize & size metal layers combindaly with power roler not less than 8 tonnes including artificial watering & leveling etc. complete as directed (Rd.35/209)	1020.67	Sqm	MR	20.00			20.00		20.00	0.00	20.00	20414
39	Providing and laying in situ cement concrete M20 with tremix treatment for 100 mm thickness for flooring with groove cutting of 4mm wide and 20mm deep with necessary refilling with bitumen and including vaccum dewatering etc. complete	541.00	Sqm	33.30/158	746.00			746.00	74.60	820.60	0.00	820.60	443945
40	Providing treatment of TREMIX vaccum dewatering over prelaid cement concrete 1:2:4 surface including fixing of M.S.Channel formwork as per required size and placing of dowel rod, vibrating the concrete by needle vibrator and leveling by	1.00	Sqm	R A	50.00			50.00		50.00	0.00	50.00	50

KINWAT PARISAR FARMERS PRODUCER CO. LTD.
GAT NO 173/1, MANDAWA, TAL-KINWAT, DIST- NANDED.

GENERAL REPORT

NAME OF WORK :- PROPOSED CONSTRUCTION OF 1020 MT CAP.WH BLDG WITH ANCILLARY WORKS AT GUT NO 173/1 ,MANDAWA,TAL-KINWAT, DIST- NANDED.

The Estimate has been Prepared for constructing Ware House .

Bldg. of 1020 MT.Cap.of amounting Rs. 10582771

As per below, Following are the Provisions being made while preparing estimate. And Estimate item rates is considered as per PWD currant e-SSR for year 2021 - 22.

- 1 Excavation
- 2 Footing ,Coloumns, Beams of RCC-M20
- 3 BBM For Foundation And Super Structure.
- 4 TMT FE-500 Bar For RCC Work
- 5 OutSide& Inside Plaster Work.
- 6 RCC Tremix Flooring Work
- 7 Steel Rolling Shutter
- 8 Steel Grill Windows (V1 & V2)
- 9 Painting / Colouring Work For Inside & Outer Side
- 10 Structrural Steel Work For Roofing Truss
- 11 Turbo Ventiletar.
- 12 colour coated Zinalume Sheet For Roofing .
- 13 Elecrification Work

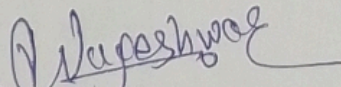

Vijay G. Nageshwar

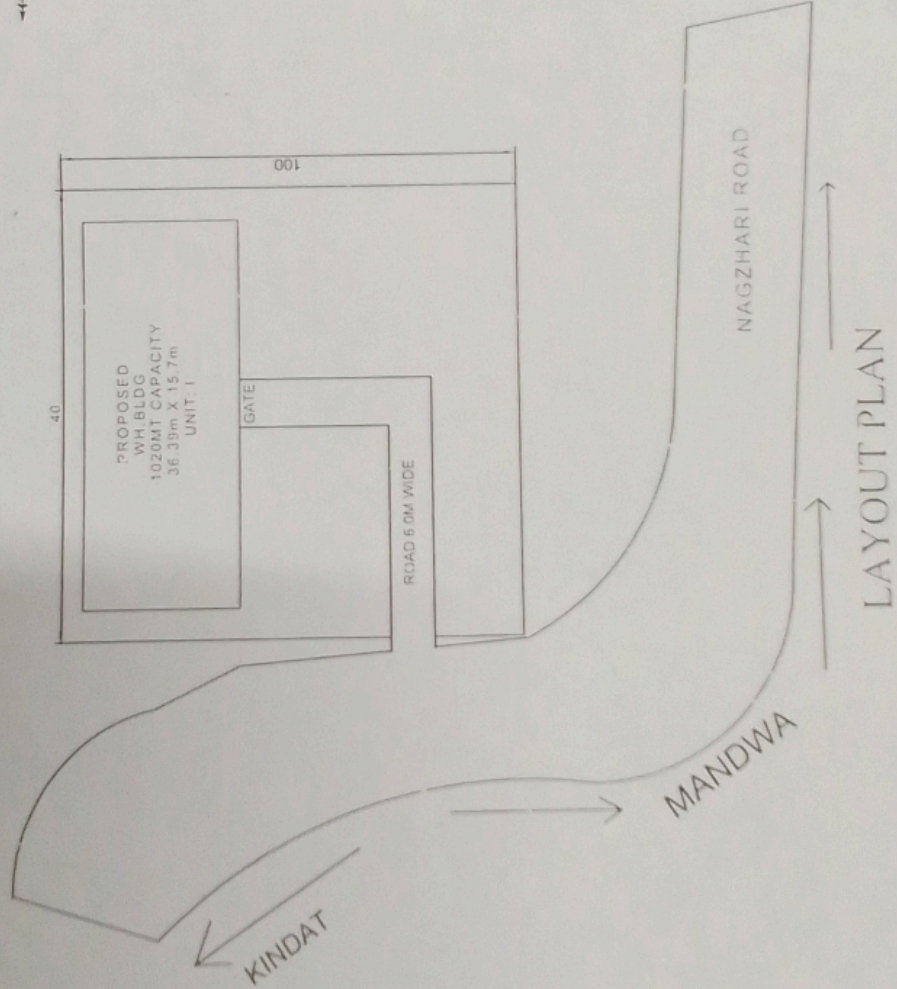
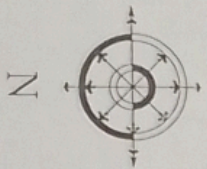
Reg. No. TP/STATE/R/2022/APL/S-1.2.97
Regd. Architect DIM & Consulting Engineer
Venkatesh Nagar, NANDED.
Cell: 8830144232, 9637881309

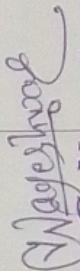

AREA STATEMENT	SQ. M.
1) PLOT AREA	4000
2) BUILT UP AREA - PROPOSED - WH. BLDG. UNIT NO. 1 (1020MT)	157.00
TOTAL	4157.00
3) GRAND TOTAL B. UP AREA	4157.00

LAYOUT PLAN
 DRAWING PROPOSED
 CAPACITY WITH
 ANCILLARY WORK
 GATE NO. 1/2/1
 AT - MANDWA
 TAL. KINWAT
 DIST: NANDED

Vijay G. Nageshwar
 Reg. No. TP/STATE/R/2022/APL/S-1.2.2.7
 Regd. Architect DIM & Consulting Engineer
 Venkatesh Nagar, NANDED.
 Cell: 8830144232, 9637881309